

Installation Guide – Weepa Extension (17-EXTW)

Weepas are available in a variety of sizes (heights and depths). Check the Technical Datasheets for exact dimensions to suit the bricks, blocks or panel being used and note that additional depth (for thicker wall sections) can be achieved by using the Weepa Extension (product code 17-EXTW) as shown below.



Guide for installation in non-rendered block walls (see separate Weepa installation guide* for rendered wall installation)

Step 1 – Select the combination of Weepa and Extension(s) to suit the desired depth. The table below summarises some common combinations.

Step 2 – Assemble the Weepa and Extension and install the assembly as per the separate Weepa installation guide*.

Step 3 – Deeper block walls might require more than 1 Extension Weepa. If the additional Extension Weepas are not assembling smoothly, rotate Weepa 180 degrees as shown.

Step 4 – If you intend on rendering, loosen the Weepa and Extension assembly and set to the desired depth. Refer to the separate Weepa installation guide* for details.

Step 4 – If not rendering, set the Weepa at a depth level with the mortar. After clean up, remove the mortar guard with a small, flat screwdriver.



If assembly is not smooth

Rotate Extension Weepa 180 degrees

And refit for smooth assembly

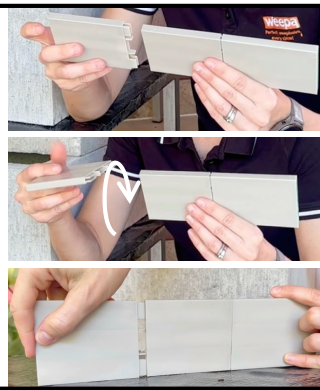

Examples of common combinations:

If working with	Weepa to use	Extension Weepa
140mm deep blocks	70mm Weepa (all models)	1 x Extension Weepa
190mm deep blocks	105mm Weepa (all models)	1 x Extension Weepa
Deeper block walls (i.e. retaining walls)	May vary to suit depth. Contact us for support in selecting the Weepa to suit your application.	2 or more Extension Weepas

Note* - Installation guide videos are available on the Weepa website or scan these QR codes:



[Extension Weepa Installation Video](#)



[Separate Weepa Installation Video](#)

For more information, visit the Weepa website (www.weepa.com.au)

Weepa Products PTY LTD (ABN 52 011 011 457) - PO Box 3325 South Brisbane QLD 4101 - Phone (07) 3844 3744 – Email - enquiries@weepa.com.au